

1490
YORK ROAD
CONDOMINIUM

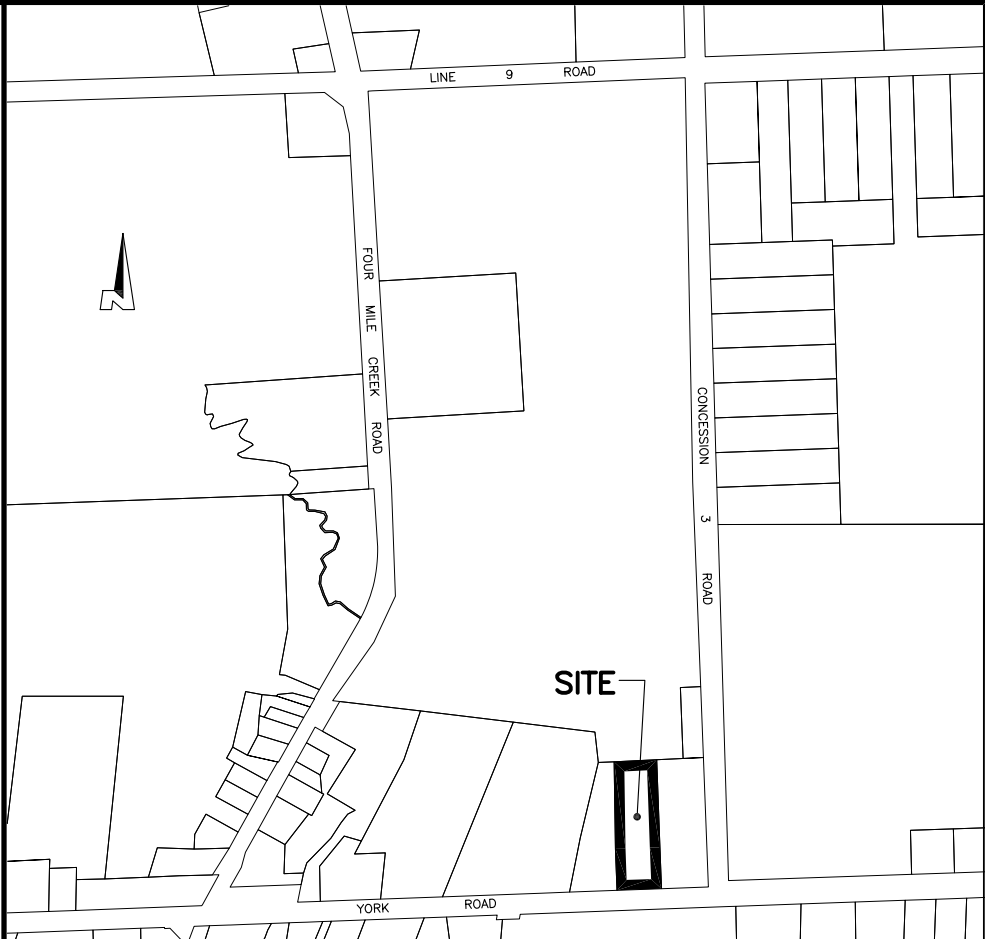

KEY PLAN
NOT TO SCALE

**DRAFT PLAN OF
VACANT LAND CONDOMINIUM**
PART OF LOT 89
GEOGRAPHIC TOWNSHIP OF NIAGARA
IN THE
**TOWN OF
NIAGARA-ON-THE-LAKE**
REGIONAL MUNICIPALITY OF NIAGARA
SCALE 1 : 300
DONALD G. CHAMBERS
ONTARIO LAND SURVEYOR

DRAFT VACANT LAND CONDOMINIUM
Subject to the conditions, if any, set forth in our letter dated _____, 20__ this draft plan is approved under Section _____ of the Planning Act.
This _____ day of _____, 20__
Authorized Signature
**THE CORPORATION OF THE
TOWN OF NIAGARA-ON-THE-LAKE**

- ADDITIONAL INFORMATION REQUIRED UNDER
SECTION 51(17) OF THE PLANNING ACT.**
- a) SEE PLAN
 - b) SEE PLAN
 - c) SEE PLAN
 - d) SINGLE RESIDENTIAL UNITS
 - e) SEE PLAN
 - f) SEE PLAN
 - g) SEE PLAN
 - h) MUNICIPAL WATER
 - i) CLAY LOAM
 - j) SEE PLAN
 - k) FULL SERVICES
 - l) SEE PLAN

AREAS
VACANT LAND CONDOMINIUM
TOTAL AREA = 5,563m²± - 100 %
SINGLE FAMILY RESIDENTIAL - UNITS 1, 2 AND 3
AREA = 4,563m²± - 82%
COMMON ELEMENTS
AREA = 854m²± - 15%
PROPOSED WIDENING AND RESERVE
AREA = 146m²± - 3%

METRIC NOTE
DISTANCES SHOWN ON THIS PLAN ARE IN METRES AND CAN BE CONVERTED TO FEET BY DIVIDING BY 0.3048.

OWNER'S CERTIFICATE
I HEREBY CERTIFY THAT I AM THE OWNER OF THE LANDS AS SHOWN.
DATE ROBERT LAURENCE - PRESIDENT
2776263 ONTARIO LIMITED
(I have authority to bind the corporation)

SURVEYOR'S CERTIFICATE
I HEREBY CERTIFY THAT THE BOUNDARIES OF THE LANDS AS SHOWN ON THIS PLAN AND THEIR RELATIONSHIP TO THE ADJACENT LANDS ARE CORRECTLY SHOWN.
MARCH 17, 2025
DATE DONALD G. CHAMBERS B. Sc., O.L.S.

**CHAMBERS AND ASSOCIATES
SURVEYING LTD**
12 THOROLD ROAD EAST
WELLAND ONTARIO
L3C 3T2
(905) 735-7841 / 735-7844
FAX (905) 735-7333
www.casl-surveying.com
DRAWN BY: D. H. T. MSCAD: 08042-2_MS DWG: 08042-2_VLC DP FILE No: 08-42-2